

Installation Manual

A-2780 ARNOTT REAR AIR SPRING FOR 2010-2014 BMW 5 SERIES (F07/F11 CHASSIS)

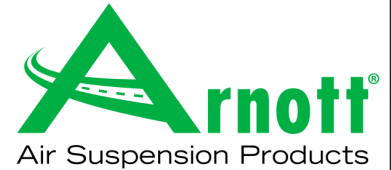

Congratulations on your purchase of an Arnott® air suspension product. We at Arnott Incorporated are proud to offer a high quality product at the industry's most competitive pricing. Thank you for your confidence in us and our product.

Proper installation is essential to experience and appreciate the benefits of this system. Please take a moment to review these installation instructions before you begin to install these components on your vehicle. The removal and installation of air suspension products should only be performed by a fully qualified, ASE Certified, professional.

It is equally important to be aware of all necessary safety measures while installing your new Air Suspension System. This includes proper lifting and immobilizing of the vehicle and isolation of any stored energy to prevent personal injury or property damage.

"Engineered to Ride, Built to Last®"



WARNING: *The air suspension system is under pressure (up to 10 bar, or 150 lbf/in). Verify pressure has been relieved and disconnect power to the air suspension system prior to disassembly. Do not allow dirt or grease to enter the system. Always wear standard hand, ear, and eye protection when servicing the air suspension system.*

Arnott® is committed to the quality of its products. If you have a question or problem with any Arnott product, please contact Arnott by calling **800-251-8993** during normal business hours or email techassistance@arnottinc.com.

GENERAL INFORMATION:

Reading this manual signifies your agreement to the terms of the general release, waiver of liability, and hold harmless agreement, the full text of which is available at www.arnottinc.com.

- Not to be stored below 5°F (-15°C) or above 122°F (50°C).
- Avoid damage to air lines and cables.
- Removal and installation is only to be performed by fully qualified personnel.
- Use car manufacturer's diagnostic software.

CAUTION: *Damage to the vehicle and air suspension system can be incurred if work is carried out in a manner other than specified in the instructions or in a different sequence.*



To avoid the possibility of short circuits while working with electric components consult your owner's manual on how to disconnect your battery.



Consult your vehicle owner's manual, service manual, or car dealer for the correct jacking points on your vehicle and for additional care, safety and maintenance instructions. Under no circumstances should any work be completed underneath the vehicle if it is not adequately supported, as serious injuries and death can occur.

AIR SPRING REMOVAL

1. SET STEERING TO STRAIGHT AHEAD.
2. RAISE VEHICLE.
3. REMOVE REAR WHEEL. (FIGURE 1)



FIGURE 1

4. LOOSEN AND REMOVE THE FASTENERS HOLDING THE REAR LOWER PLASTIC SHIELD TO EXPOSE THE VEHICLE'S AIR SUSPENSION COMPRESSOR. (FIGURE 2, 3)



FIGURE 2



FIGURE 3

5. LOCATE THE VALVE BLOCK NEAR THE COMPRESSOR ON THE REAR SIDE OF THE VEHICLE. REMOVE THE APPLICABLE AIR LINE TO DEFLATE THE REAR AIR SPRING. (FIGURE 4, 5)



FIGURE 4



FIGURE 5

6. AFTER THE AIR SPRING HAS DEFLATED, UNCLIP THE LOWER PISTON BY SQUEEZING THE LOCKING TABS TOGETHER AND PULLING UP TO FREE IT FROM THE LOWER AIR SPRING PERCH. (FIGURE 6, 7)

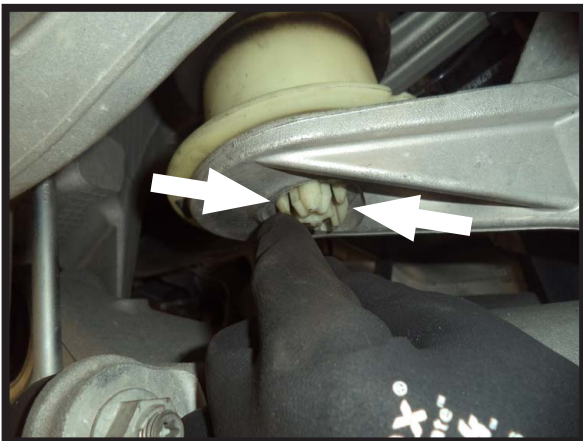

FIGURE 6

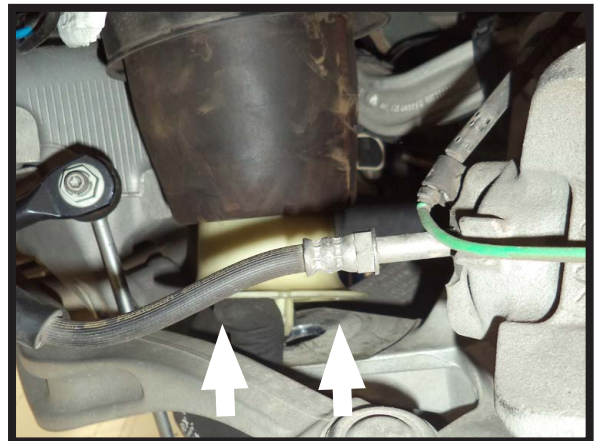

FIGURE 7

7. ROTATE THE TOP MOUNT CLOCKWISE TO UNLOCK THE AIR SPRING FROM THE VEHICLE, AND PULL DOWNWARD TO RELEASE. (FIGURE 8)

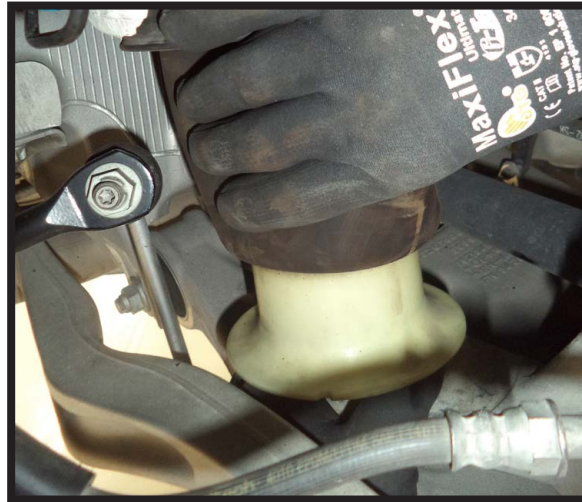

FIGURE 8

8. REMOVE THE AIR LINE FROM THE AIR SPRING BY UNSCREWING THE FITTING. REMOVE THE AIR FITTING FROM THE AIR LINE AND DISCARD. (FIGURE 9, 10)



FIGURE 9

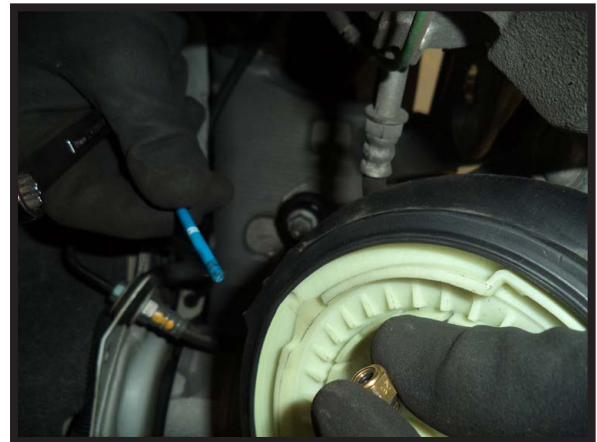

FIGURE 10

9. TO REMOVE THE AIR LINE FITTING, REMOVE THE COLLET AND THE REMAINING FITTING WILL SLIDE OFF OF THE AIR HOSE. (FIGURE F)

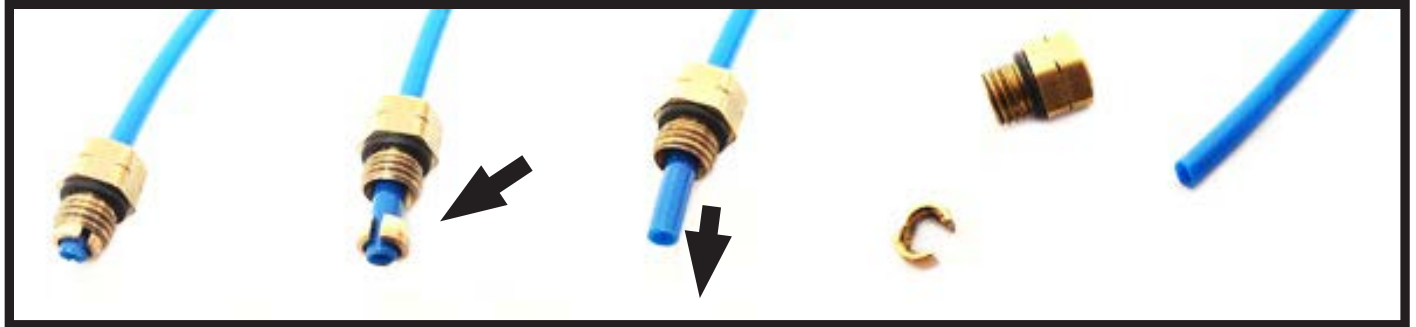



FIGURE F

10. REMOVAL COMPLETE

AIR SPRING INSTALLATION

-  *Tighten all nuts and bolts to manufacturer's specifications during the installation process.*
-  *Do not remove the air fitting from the new air spring. Doing so may cause damage and/or void warranty. Remove the white shipping pin from the new air fitting and insert the air line until fully seated.*

1. INSTALLATION IS IN REVERSE ORDER OF AIR SPRING REMOVAL.